

Frequency Mixer WIDE BAND

ZX05-43+

Level 7 (LO Power +7 dBm) 750 to 4200 MHz



Maximum Ratings

Operating Temperature	-40°C to 85°C
Storage Temperature	-55°C to 100°C
RF Power	50mW

Permanent damage may occur if any of these limits are exceeded.

Coaxial Connections

LO	2
RF	3
IF	1

Features

- wide bandwidth, 750 to 4200 MHz
- low conversion loss, 6.1 dB typ.
- excellent L-R isolation, 35 dB typ.
- rugged construction
- small size
- useable as up and down converter
- protected by US patents, 6,790,049 and 7,027,795

Applications

- cellular
- defense and weather radar
- defense communications
- PCN
- WCDMA
- WIFI
- blue tooth
- VSAT
- ISM

CASE STYLE: FL905

Connectors	Model
SMA	ZX05-43-S+

+RoHS Compliant

The +Suffix identifies RoHS Compliance. See our web site for RoHS Compliance methodologies and qualifications

Outline Drawing

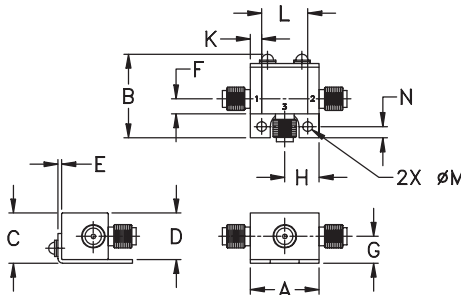

Outline Dimensions (inch/mm)

A	B	C	D	E	F	G
.74	.90	.54	.50	.04	.16	.29
18.80	22.86	13.72	12.70	1.02	4.06	7.37
H	J	K	L	M	N	wt
.37	--	.122	.496	.106	.122	grams
9.40	--	3.10	12.60	2.69	3.10	20.0

Electrical Specifications

FREQUENCY (MHz)	CONVERSION LOSS* (dB)	LO-RF ISOLATION (dB)		LO-IF ISOLATION (dB)		IP3 at center band (dBm)			
		Typ.	Min.	Typ.	Min.				
LO/RF f _L -f _u	IF	Typ.	σ	Max.	Typ.	Min.	Typ.		
750-4200	DC-1500								
750-2500		6.3	0.1	8.3	35	29	24	9	12
2500-4200		6.0	0.1	8.9	26	22	20	13	12

1 dB COMPR.: +1 dBm typ.

* Conversion loss at 30 MHz IF. σ is a measure of repeatability from unit to unit.

Typical Performance Data

Frequency (MHz)	Conversion Loss (dB)	Isolation L-R (dB)	Isolation L-I (dB)	VSWR RF Port (:1)	VSWR LO Port (:1)	
					LO +7dBm	LO +7dBm
RF	LO	LO +7dBm	LO +7dBm	LO +7dBm	LO +7dBm	LO +7dBm
750.00	780.00	7.32	41.67	24.97	2.28	9.85
950.00	980.00	6.99	39.87	26.96	2.12	3.01
1150.00	1180.00	6.57	41.71	30.28	3.13	1.46
1350.00	1380.00	6.50	35.27	33.17	3.18	1.13
1550.00	1580.00	6.39	33.25	28.75	2.99	1.71
1750.00	1780.00	6.56	35.54	21.12	2.87	2.05
1950.00	1980.00	6.87	33.83	13.03	3.17	1.91
2150.00	2180.00	6.83	34.63	12.22	3.02	1.91
2350.00	2380.00	6.23	32.19	14.93	2.37	2.03
2550.00	2580.00	6.67	30.60	17.84	2.54	1.97
2750.00	2780.00	5.56	29.18	19.08	1.71	1.51
2950.00	2980.00	5.24	28.19	21.52	1.40	1.40
3150.00	3180.00	5.47	26.03	25.95	1.63	1.16
3350.00	3380.00	5.84	26.52	25.86	1.63	1.18
3550.00	3580.00	6.31	25.30	22.00	2.33	1.59
3750.00	3780.00	6.53	25.45	19.15	2.80	2.01
3950.00	3980.00	7.42	26.91	19.85	3.70	2.67
4150.00	4180.00	7.65	26.78	16.35	3.79	3.59
4190.00	4220.00	7.83	27.09	15.96	3.73	3.79
4210.00	4240.00	7.57	27.32	15.67	3.69	3.84

Electrical Schematic

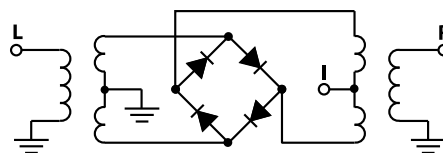

Notes

- Performance and quality attributes and conditions not expressly stated in this specification document are intended to be excluded and do not form a part of this specification document.
- Electrical specifications and performance data contained in this specification document are based on Mini-Circuit's applicable established test performance criteria and measurement instructions.
- The parts covered by this specification document are subject to Mini-Circuits standard limited warranty and terms and conditions (collectively, "Standard Terms"); Purchasers of this part are entitled to the rights and benefits contained therein. For a full statement of the Standard Terms and the exclusive rights and remedies thereunder, please visit Mini-Circuits' website at www.minicircuits.com/MCLStore/terms.jsp



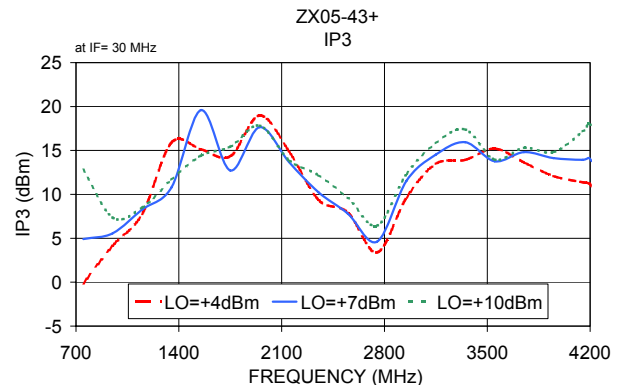
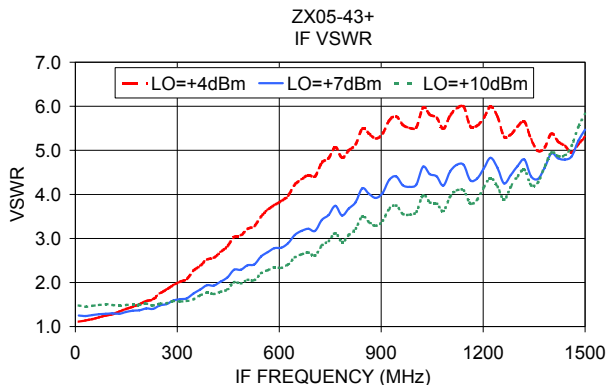
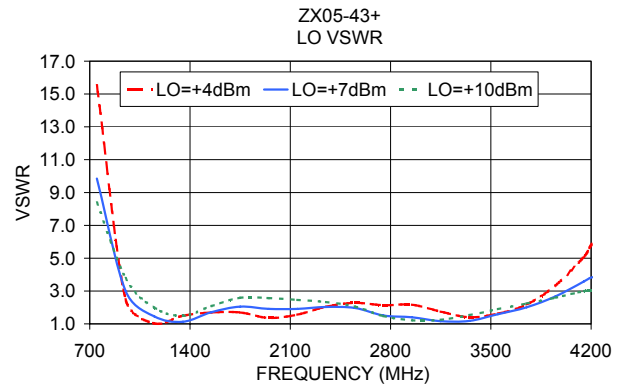
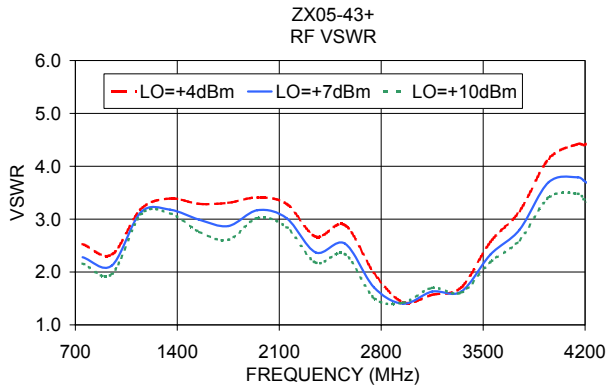
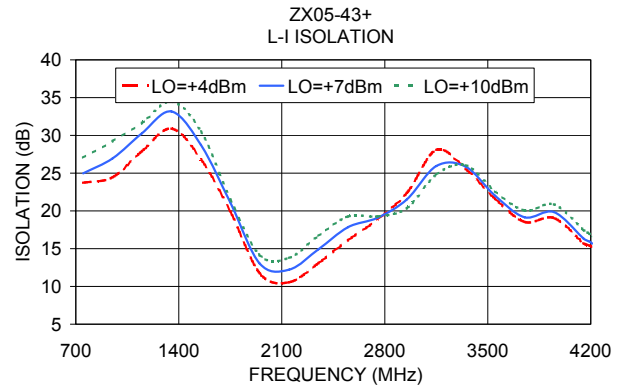
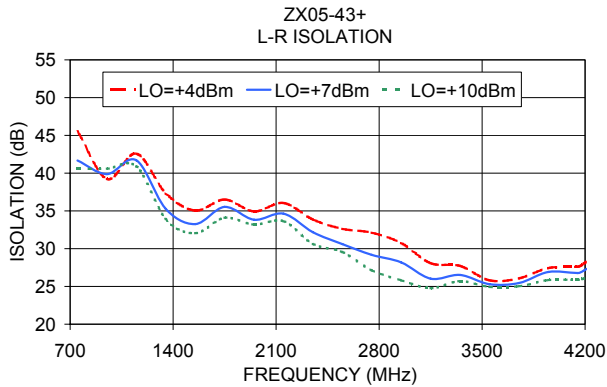
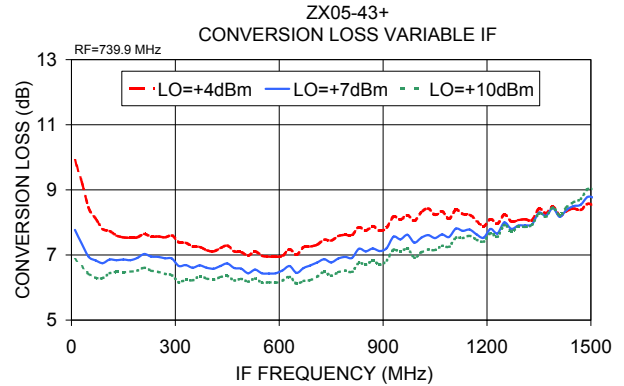
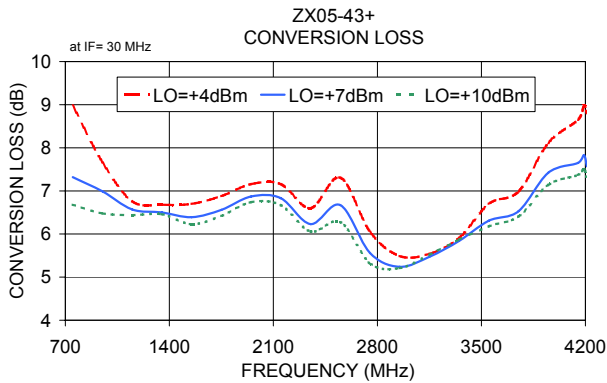

Notes

- A. Performance and quality attributes and conditions not expressly stated in this specification document are intended to be excluded and do not form a part of this specification document.
- B. Electrical specifications and performance data contained in this specification document are based on Mini-Circuit's applicable established test performance criteria and measurement instructions.
- C. The parts covered by this specification document are subject to Mini-Circuits standard limited warranty and terms and conditions (collectively, "Standard Terms"); Purchasers of this part are entitled to the rights and benefits contained therein. For a full statement of the Standard Terms and the exclusive rights and remedies thereunder, please visit Mini-Circuits' website at www.minicircuits.com/MCLStore/terms.jsp



Frequency Mixer

ZX05-43+

Typical Performance Data

RF (IN) (MHz)	LO (MHz)	CONVERSION LOSS IF FIXED @IF(OUT)=30MHz (dB)		
		@LO (dBm)		
		+4	+7	+10
570.0	600.0	23.98	16.31	10.58
670.0	700.0	12.96	8.91	7.39
770.0	800.0	8.24	6.80	6.23
870.0	900.0	7.39	6.58	6.10
970.0	1000.0	7.27	6.66	6.16
1070.0	1100.0	6.85	6.39	6.08
1170.0	1200.0	6.53	6.31	6.18
1270.0	1300.0	6.56	6.40	6.28
1370.0	1400.0	6.44	6.24	6.18
1470.0	1500.0	6.31	6.03	5.98
1570.0	1600.0	6.38	6.10	5.97
1670.0	1700.0	6.48	6.18	6.05
1770.0	1800.0	6.67	6.35	6.22
1870.0	1900.0	6.66	6.38	6.27
1970.0	2000.0	6.70	6.46	6.34
2070.0	2100.0	6.65	6.39	6.26
2170.0	2200.0	6.76	6.41	6.23
2270.0	2300.0	6.73	6.30	6.11
2370.0	2400.0	6.10	5.77	5.64
2470.0	2500.0	6.75	6.16	5.86
2570.0	2600.0	6.74	6.30	6.01
2670.0	2700.0	6.11	5.64	5.39
2770.0	2800.0	5.87	5.42	5.19
2870.0	2900.0	5.59	5.17	5.04
2970.0	3000.0	5.40	5.14	5.07
3070.0	3100.0	5.39	5.22	5.20
3170.0	3200.0	5.44	5.30	5.31
3270.0	3300.0	5.58	5.43	5.43
3370.0	3400.0	5.85	5.69	5.67
3470.0	3500.0	6.25	5.96	5.87
3550.0	3580.0	6.60	6.16	5.97
3650.0	3680.0	6.77	6.39	6.24
3730.0	3760.0	6.87	6.41	6.25
3830.0	3860.0	7.46	6.80	6.47
3910.0	3940.0	7.90	7.25	6.91
4010.0	4040.0	8.28	7.42	7.10
4090.0	4120.0	8.38	7.48	7.17
4190.0	4220.0	8.66	7.59	7.25
4270.0	4300.0	8.74	7.45	7.08
4370.0	4400.0	10.24	8.08	7.52

RF (IN) (MHz)	LO (MHz)	IP3 INPUT (dBm)		
		@LO (dBm)		
		+4	+7	+10
570.0	600.0	-8.64	-4.33	3.40
670.0	700.0	-2.95	2.21	6.33
770.0	800.0	0.44	5.75	11.26
870.0	900.0	3.97	6.49	9.41
970.0	1000.0	4.25	5.47	7.40
1070.0	1100.0	6.18	8.23	10.02
1170.0	1200.0	7.86	9.75	10.86
1270.0	1300.0	9.31	9.66	11.43
1370.0	1400.0	14.24	11.48	11.29
1470.0	1500.0	11.04	9.18	13.40
1570.0	1600.0	16.18	16.79	15.37
1670.0	1700.0	14.14	14.68	16.27
1770.0	1800.0	13.39	14.21	16.98
1870.0	1900.0	12.98	18.24	20.86
1970.0	2000.0	17.77	16.50	16.60
2070.0	2100.0	14.58	15.00	15.13
2170.0	2200.0	13.34	12.55	12.82
2270.0	2300.0	10.32	11.83	12.93
2370.0	2400.0	9.97	10.29	12.04
2470.0	2500.0	14.78	12.02	10.76
2570.0	2600.0	7.25	7.05	8.31
2670.0	2700.0	4.69	5.34	5.78
2770.0	2800.0	3.67	5.22	7.47
2870.0	2900.0	6.23	10.73	12.04
2970.0	3000.0	9.94	11.81	12.51
3070.0	3100.0	11.19	13.35	14.32
3170.0	3200.0	12.90	14.62	16.03
3270.0	3300.0	13.62	16.26	17.39
3370.0	3400.0	14.50	15.76	17.03
3470.0	3500.0	15.22	13.85	15.42
3550.0	3580.0	15.76	13.91	13.92
3650.0	3680.0	16.67	15.38	13.37
3730.0	3760.0	14.79	15.24	15.99
3830.0	3860.0	19.92	17.55	17.08
3910.0	3940.0	11.50	13.27	14.61
4010.0	4040.0	12.53	14.58	15.30
4090.0	4120.0	12.06	14.48	16.36
4190.0	4220.0	11.76	14.13	17.74
4270.0	4300.0	13.77	17.36	17.70
4370.0	4400.0	10.99	19.13	20.24

RF (IN) (MHz)	LO (MHz)	COMPRESSION @RF IN=+1dBm (dB)		
		@LO (dBm)		
		+4	+7	+10
570.0	600.0	-8.13	-3.38	-0.08
670.0	700.0	0.06	1.48	0.94
770.0	800.0	2.93	2.21	1.68
870.0	900.0	2.38	2.16	1.90
970.0	1000.0	1.80	1.68	1.59
1070.0	1100.0	1.63	1.38	1.15
1170.0	1200.0	1.23	0.96	0.76
1270.0	1300.0	0.76	0.55	0.48
1370.0	1400.0	0.67	0.44	0.32
1470.0	1500.0	0.68	0.54	0.40
1570.0	1600.0	0.58	0.43	0.34
1670.0	1700.0	0.61	0.43	0.32
1770.0	1800.0	0.58	0.35	0.20
1870.0	1900.0	0.56	0.30	0.17
1970.0	2000.0	0.49	0.28	0.18
2070.0	2100.0	0.55	0.34	0.21
2170.0	2200.0	0.63	0.43	0.31
2270.0	2300.0	0.75	0.56	0.40
2370.0	2400.0	0.88	0.61	0.44
2470.0	2500.0	0.92	0.67	0.49
2570.0	2600.0	1.09	0.93	0.81
2670.0	2700.0	1.29	1.16	1.08
2770.0	2800.0	1.43	1.15	0.97
2870.0	2900.0	1.31	0.95	0.73
2970.0	3000.0	1.07	0.67	0.54
3070.0	3100.0	0.86	0.47	0.37
3170.0	3200.0	0.78	0.37	0.26
3270.0	3300.0	0.91	0.45	0.28
3370.0	3400.0	0.94	0.50	0.30
3470.0	3500.0	0.88	0.53	0.35
3550.0	3580.0	0.91	0.62	0.43
3650.0	3680.0	0.66	0.43	0.30
3730.0	3760.0	0.69	0.46	0.33
3830.0	3860.0	0.79	0.58	0.46
3910.0	3940.0	0.55	0.44	0.38
4010.0	4040.0	0.47	0.39	0.35
4090.0	4120.0	0.40	0.30	0.25
4190.0	4220.0	0.45	0.32	0.24
4270.0	4300.0	0.49	0.43	0.28
4370.0	4400.0	0.07	0.39	0.28

Frequency Mixer

ZX05-43+

Typical Performance Data

IF (OUT) (MHz)	LO (MHz)	CONVERSION LOSS VS. IF FREQUENCY @RF(IN)=2475MHz (dB)	IF (OUT) (MHz)	LO (MHz)	CONVERSION LOSS VS. IF FREQUENCY @RF(IN)=739.9MHz (dB)	IF (OUT) (MHz)	LO (MHz)	CONVERSION LOSS VS. IF FREQUENCY @RF(IN)=4210MHz (dB)
		@LO (dBm)			@LO (dBm)			@LO (dBm)
		+7			+7			+7
1390.0	1085.0	10.75	10.1	750.0	7.72	1410.0	2800.0	11.06
1314.4	1160.6	9.36	50.1	790.0	7.07	1370.0	2840.0	10.71
1238.8	1236.2	7.61	90.1	830.0	6.74	1330.0	2880.0	10.26
1163.2	1311.8	6.80	130.1	870.0	6.74	1290.0	2920.0	9.82
1087.5	1387.5	7.01	170.1	910.0	6.78	1250.0	2960.0	9.69
1011.9	1463.1	7.66	210.1	950.0	6.90	1210.0	3000.0	9.88
936.3	1538.7	8.50	250.1	990.0	6.87	1170.0	3040.0	9.63
860.7	1614.3	9.24	290.1	1030.0	6.79	1130.0	3080.0	9.37
785.1	1689.9	8.73	330.1	1070.0	6.68	1090.0	3120.0	9.04
709.5	1765.5	7.63	370.1	1110.0	6.55	1050.0	3160.0	9.02
633.8	1841.2	7.01	410.1	1150.0	6.49	1010.0	3200.0	8.81
558.2	1916.8	6.59	450.1	1190.0	6.57	970.0	3240.0	8.83
482.6	1992.4	6.34	490.1	1230.0	6.49	930.0	3280.0	8.88
407.0	2068.0	5.98	530.1	1270.0	6.39	890.0	3320.0	8.72
331.4	2143.6	5.80	570.1	1310.0	6.39	850.0	3360.0	8.72
255.8	2219.2	5.52	610.1	1350.0	6.52	810.0	3400.0	8.69
180.1	2294.9	5.44	650.1	1390.0	6.59	770.0	3440.0	8.84
104.5	2370.5	5.64	690.1	1430.0	6.65	730.0	3480.0	9.14
28.9	2446.1	6.07	730.1	1470.0	6.81	690.0	3520.0	9.06
52.2	2527.2	6.32	770.1	1510.0	6.88	650.0	3560.0	9.19
136.5	2611.5	6.87	810.1	1550.0	7.05	610.0	3600.0	9.19
220.8	2695.8	7.00	850.1	1590.0	7.23	570.0	3640.0	9.13
305.1	2780.1	6.92	890.1	1630.0	7.25	530.0	3680.0	9.03
389.5	2864.5	6.52	930.1	1670.0	7.55	490.0	3720.0	8.92
473.8	2948.8	6.35	970.1	1710.0	7.59	450.0	3760.0	8.90
537.0	3012.0	6.47	1010.1	1750.0	7.51	430.0	3780.0	8.86
621.4	3096.4	6.59	1050.1	1790.0	7.54	390.0	3820.0	8.58
684.6	3159.6	6.57	1090.1	1830.0	7.67	370.0	3840.0	8.49
768.9	3243.9	6.53	1130.1	1870.0	7.81	330.0	3880.0	8.29
832.2	3307.2	6.69	1170.1	1910.0	7.72	310.0	3900.0	8.12
916.5	3391.5	6.62	1210.1	1950.0	7.72	270.0	3940.0	7.95
979.7	3454.7	6.62	1250.1	1990.0	7.95	250.0	3960.0	7.83
1064.1	3539.1	6.79	1290.1	2030.0	7.97	210.0	4000.0	7.58
1127.3	3602.3	6.91	1330.1	2070.0	8.14	190.0	4020.0	7.55
1211.6	3686.6	7.26	1370.1	2110.0	8.50	150.0	4060.0	7.54
1274.9	3749.9	7.50	1410.1	2150.0	8.43	130.0	4080.0	7.52
1359.2	3834.2	8.02	1450.1	2190.0	8.63	90.0	4120.0	7.50
1422.4	3897.4	8.43	1510.1	2250.0	8.84	70.0	4140.0	7.56
1506.8	3981.8	9.41	1550.1	2290.0	9.40	30.0	4180.0	7.54
1570.0	4045.0	10.52	1610.1	2350.0	10.20	10.0	4200.0	7.76

REV. X2
ZX05-43+
101011
Page 2 of 5



P.O. Box 350188, Brooklyn, New York 11235-0003 (718) 934-4500 Fax (718) 332-4851 For detailed performance specs & shopping online see Mini-Circuits web site



The Design Engineers Search Engine Provides ACTUAL Data Instantly From MIN-CIRCUITS At: www.minicircuits.com

IF/RF MICROWAVE COMPONENTS



Frequency Mixer

ZX05-43+

Typical Performance Data

LO (MHz)	LO-RF ISOLATION (dB)			LO-IF ISOLATION (dB)		
	@LO (dBm)			@LO (dBm)		
	+4	+7	+10	+4	+7	+10
600.0	58.55	58.29	57.35	28.34	28.38	28.54
700.0	52.30	52.65	46.08	25.70	25.88	26.74
800.0	43.48	40.85	40.22	23.49	25.00	27.16
900.0	37.65	37.94	38.49	23.44	25.83	28.30
1000.0	41.15	41.71	42.21	24.73	27.26	29.55
1100.0	45.37	44.93	44.32	26.34	28.93	31.15
1200.0	41.93	40.69	39.62	28.12	30.39	31.62
1300.0	39.18	36.90	35.47	29.97	31.92	32.43
1400.0	36.89	34.53	33.17	31.14	33.49	34.99
1500.0	35.19	33.19	31.45	30.46	33.37	36.32
1600.0	34.96	33.39	32.27	26.25	27.95	29.43
1700.0	35.70	34.32	33.47	23.47	24.66	25.31
1800.0	36.25	35.29	34.10	18.89	20.05	20.58
1900.0	35.11	33.92	32.99	14.41	15.62	16.43
2000.0	34.96	34.15	33.44	11.12	12.57	13.70
2100.0	35.20	34.20	33.30	10.05	11.68	13.04
2200.0	35.84	34.60	33.47	10.73	12.37	13.91
2300.0	34.81	33.44	32.32	12.00	13.72	15.44
2400.0	33.84	31.95	30.70	13.42	15.14	16.94
2500.0	35.16	33.42	32.14	14.88	16.53	18.22
2600.0	32.58	29.90	28.43	16.33	17.97	19.30
2700.0	32.85	30.45	28.41	17.65	18.71	19.53
2800.0	31.95	29.02	26.43	19.10	19.29	19.13
2900.0	32.28	29.17	26.23	20.57	20.20	19.63
3000.0	30.11	27.69	25.50	22.86	21.97	20.80
3100.0	28.54	26.30	24.67	25.89	23.92	22.59
3200.0	27.72	25.87	24.42	28.22	26.57	25.42
3300.0	28.06	26.50	25.46	25.50	24.71	24.27
3400.0	27.49	26.36	25.60	25.02	25.41	25.84
3500.0	26.43	25.71	24.92	23.13	23.43	23.89
3580.0	25.76	25.33	24.67	21.34	21.77	22.13
3680.0	25.60	25.28	24.59	18.98	19.56	20.07
3760.0	25.86	25.44	24.76	18.21	18.81	19.46
3860.0	26.73	26.32	25.62	19.33	19.71	20.44
3940.0	27.05	26.54	25.69	19.81	20.31	21.07
4040.0	27.51	26.96	26.02	17.33	17.99	19.15
4120.0	27.44	26.86	25.92	16.07	16.77	17.86
4220.0	27.85	26.99	26.06	15.28	15.82	16.93
4300.0	28.92	28.12	26.31	14.91	15.53	16.33
4400.0	29.84	28.81	27.09	14.66	15.08	15.75

RF (IN) (MHz)	LO (MHz)	RF-IF ISOLATION (dB)		
		@LO (dBm)		
		+4	+7	+10
570.0	600.0	28.29	26.77	22.36
670.0	700.0	24.39	21.45	17.14
770.0	800.0	17.80	14.81	13.70
870.0	900.0	13.45	12.51	11.99
970.0	1000.0	14.01	13.25	12.71
1070.0	1100.0	17.02	16.20	15.67
1170.0	1200.0	19.97	19.46	19.14
1270.0	1300.0	22.98	22.66	22.25
1370.0	1400.0	24.53	24.70	25.02
1470.0	1500.0	25.16	25.05	25.29
1570.0	1600.0	25.66	26.04	26.28
1670.0	1700.0	24.69	24.89	25.09
1770.0	1800.0	26.30	26.41	26.25
1870.0	1900.0	29.19	28.87	28.72
1970.0	2000.0	34.38	34.11	33.91
2070.0	2100.0	39.86	39.08	38.87
2170.0	2200.0	37.73	37.50	37.69
2270.0	2300.0	39.51	39.83	40.64
2370.0	2400.0	39.74	39.45	39.60
2470.0	2500.0	38.99	39.57	40.17
2570.0	2600.0	34.55	34.32	34.25
2670.0	2700.0	31.20	30.45	29.91
2770.0	2800.0	28.35	28.02	27.72
2870.0	2900.0	26.48	25.65	25.60
2970.0	3000.0	26.00	25.90	26.16
3070.0	3100.0	24.73	24.30	24.42
3170.0	3200.0	24.59	23.84	23.52
3270.0	3300.0	31.37	29.55	28.22
3370.0	3400.0	20.20	19.43	19.05
3470.0	3500.0	20.05	19.42	19.06
3550.0	3580.0	19.89	19.26	19.02
3650.0	3680.0	22.44	21.34	20.96
3730.0	3760.0	22.67	21.25	20.70
3830.0	3860.0	25.15	24.06	23.68
3910.0	3940.0	32.64	30.62	29.53
4010.0	4040.0	42.26	42.88	40.86
4090.0	4120.0	30.51	28.99	27.82
4190.0	4220.0	26.67	24.50	23.16
4270.0	4300.0	26.35	23.78	22.49
4370.0	4400.0	28.74	27.51	26.94

Frequency Mixer

ZX05-43+

Typical Performance Data

RF (IN) (MHz)	LO (MHz)	RF VSWR (:1)		
		@LO (dBm)		
		+4	+7	+10
570.0	600.0	12.99	8.68	5.28
670.0	700.0	4.46	3.25	3.18
770.0	800.0	2.34	2.10	1.97
870.0	900.0	1.93	1.70	1.56
970.0	1000.0	2.56	2.35	2.16
1070.0	1100.0	3.10	2.93	2.80
1170.0	1200.0	3.29	3.21	3.15
1270.0	1300.0	3.42	3.33	3.29
1370.0	1400.0	3.46	3.20	3.08
1470.0	1500.0	3.35	3.01	2.72
1570.0	1600.0	3.19	2.88	2.66
1670.0	1700.0	3.23	2.84	2.53
1770.0	1800.0	3.27	2.87	2.65
1870.0	1900.0	3.22	2.92	2.73
1970.0	2000.0	3.31	3.05	2.88
2070.0	2100.0	3.29	3.01	2.82
2170.0	2200.0	3.50	3.20	2.99
2270.0	2300.0	3.38	3.07	2.86
2370.0	2400.0	2.58	2.27	2.08
2470.0	2500.0	3.00	2.70	2.46
2570.0	2600.0	2.87	2.56	2.33
2670.0	2700.0	2.43	2.17	1.95
2770.0	2800.0	1.94	1.67	1.47
2870.0	2900.0	1.56	1.39	1.35
2970.0	3000.0	1.45	1.43	1.44
3070.0	3100.0	1.50	1.54	1.60
3170.0	3200.0	1.52	1.57	1.64
3270.0	3300.0	1.56	1.55	1.59
3370.0	3400.0	1.66	1.57	1.55
3470.0	3500.0	2.07	1.90	1.83
3550.0	3580.0	2.57	2.33	2.18
3650.0	3680.0	3.00	2.75	2.60
3730.0	3760.0	3.23	2.92	2.70
3830.0	3860.0	3.63	3.24	2.95
3910.0	3940.0	4.02	3.63	3.35
4010.0	4040.0	4.41	3.88	3.57
4090.0	4120.0	4.52	3.93	3.60
4190.0	4220.0	4.64	3.93	3.57
4270.0	4300.0	4.35	3.54	3.14
4370.0	4400.0	4.98	3.94	3.57

LO (MHz)	LO VSWR (:1)		
	@LO (dBm)		
	+4	+7	+10
600.0	35.46	34.75	32.18
700.0	26.74	22.29	15.13
800.0	12.35	8.35	7.56
900.0	4.32	4.35	5.02
1000.0	2.26	2.81	3.58
1100.0	1.37	1.90	2.55
1200.0	1.11	1.36	1.86
1300.0	1.41	1.06	1.49
1400.0	1.57	1.18	1.47
1500.0	1.67	1.48	1.78
1600.0	1.74	1.78	2.18
1700.0	1.77	2.03	2.56
1800.0	1.67	2.06	2.64
1900.0	1.45	1.97	2.64
2000.0	1.36	1.92	2.58
2100.0	1.42	1.89	2.52
2200.0	1.62	1.94	2.48
2300.0	1.89	2.01	2.42
2400.0	2.13	2.08	2.35
2500.0	2.29	2.06	2.22
2600.0	2.35	2.00	2.03
2700.0	2.25	1.74	1.74
2800.0	2.12	1.44	1.34
2900.0	2.10	1.38	1.21
3000.0	2.09	1.34	1.18
3100.0	1.91	1.24	1.22
3200.0	1.72	1.15	1.32
3300.0	1.57	1.15	1.44
3400.0	1.51	1.25	1.57
3500.0	1.57	1.42	1.72
3580.0	1.69	1.57	1.84
3680.0	1.89	1.76	2.01
3760.0	2.09	1.91	2.12
3860.0	2.55	2.19	2.29
3940.0	2.99	2.45	2.44
4040.0	3.86	2.94	2.70
4120.0	4.52	3.34	2.92
4220.0	5.65	3.82	3.05
4300.0	6.51	4.16	3.06
4400.0	8.08	5.20	3.45

IF (OUT) (MHz)	IF VSWR @LO=4200MHz (:1)		
	@LO (dBm)		
	+4	+7	+10
10.0	1.09	1.26	1.49
49.7	1.16	1.26	1.48
89.5	1.24	1.29	1.49
129.2	1.33	1.32	1.49
168.9	1.44	1.36	1.51
208.7	1.56	1.40	1.51
248.4	1.72	1.48	1.53
288.1	1.92	1.57	1.57
327.9	2.11	1.68	1.61
367.6	2.35	1.83	1.71
407.3	2.58	1.97	1.79
447.1	2.82	2.13	1.89
486.8	3.09	2.32	2.03
526.5	3.33	2.49	2.14
566.3	3.61	2.69	2.29
606.0	3.86	2.86	2.40
645.7	4.13	3.05	2.55
685.5	4.40	3.22	2.68
725.2	4.64	3.40	2.82
764.9	4.84	3.56	2.98
804.7	5.02	3.70	3.12
844.4	5.22	3.92	3.30
884.1	5.31	3.96	3.35
923.9	5.52	4.15	3.52
963.6	5.52	4.20	3.56
1003.3	5.59	4.24	3.64
1043.1	5.68	4.37	3.75
1082.8	5.61	4.36	3.77
1122.5	5.77	4.51	3.95
1162.3	5.65	4.47	3.95
1202.0	5.68	4.56	4.11
1241.7	5.65	4.59	4.21
1281.5	5.47	4.56	4.28
1321.2	5.49	4.68	4.48
1360.9	5.23	4.61	4.55
1380.8	5.22	4.73	4.73
1420.5	5.28	4.96	5.04
1440.4	5.22	5.00	5.16
1480.1	5.22	5.25	5.54
1500.0	5.30	5.44	5.79

Harmonics Tables

RF HARMONICS ORDER

	(-dBm)	(-dBc)										
0	-	-	+11	9	9	30	26	42	36	45	41	---
1	-	33	+0	41	18	31	33	>70	48	>70	55	60
2	>90	55	56	61	53	69	54	61	67	>70	>70	>70
3	>90	65	63	>70	63	>70	67	>70	69	>70	>70	>70
4	>90	>70	>70	>70	>70	>70	>70	>70	>70	>70	>70	>70
5	>90	>70	>70	>70	>70	>70	>70	>70	>70	>70	>70	>70
6	>90	>70	>70	>70	>70	>70	>70	>70	>70	>70	>70	>70
7	>90	>70	>70	>70	>70	>70	>70	>70	>70	>70	>70	>70
8	>90	>70	>70	>70	>70	>70	>70	>70	>70	>70	>70	>70
9	>90	>70	>70	>70	>70	>70	>70	>70	>70	>70	>70	>70
10	---	---	>70	>70	>70	>70	>70	>70	>70	>70	>70	>70
	RF CAL	0	1	2	3	4	5	6	7	8	9	10

LO HARMONICS ORDER

Test conditions: RF IN: 2475 MHz; -14.00 dBm.
 LO IN: 2505 MHz; +7.00 dBm
 IF OUT: 30 MHz; -20.26 dBm

RF HARMONICS ORDER

	(-dBm)	(-dBc)										
0	-	-	+1	19	19	47	38	53	50	57	53	---
1	-	32	+0	43	18	36	33	71	47	73	60	62
2	71	47	49	48	45	56	48	55	58	70	71	71
3	>90	44	40	65	40	61	47	49	53	>80	67	>80
4	>90	70	62	62	62	57	63	64	62	67	79	75
5	>90	75	66	70	61	>80	56	>80	62	77	68	>80
6	>90	>80	>80	>80	>80	75	79	68	80	78	78	>80
7	>90	>80	>80	>80	>80	>80	77	>80	71	>80	>80	>80
8	>90	>80	>80	>80	>80	>80	>80	>80	>80	>80	>80	>80
9	>90	>80	>80	>80	>80	>80	>80	>80	>80	>80	>80	>80
10	---	---	>80	>80	>80	>80	>80	>80	>80	>80	>80	>80
	RF CAL	0	1	2	3	4	5	6	7	8	9	10

LO HARMONICS ORDER

Test conditions: RF IN: 2475 MHz; -4.00 dBm.
 LO IN: 2505 MHz; +7.00 dBm
 IF OUT: 30 MHz; -10.31 dBm

Notes: 1. All Harmonics are in (dBc) relative to IF OUTPUT.
 2. + entry denotes harmonics are in (dBc) above IF OUTPUT.

REV. X2
 ZX05-43+
 101011
 Page 5 of 5



P.O. Box 350188, Brooklyn, New York 11235-0003 (718) 934-4500 Fax (718) 332-4851 For detailed performance specs & shopping online see Mini-Circuits web site



The Design Engineers Search Engine Provides ACTUAL Data Instantly From MIN-CIRCUITS At: www.minicircuits.com

IF/RF MICROWAVE COMPONENTS

Typical Performance Curves

Conversion Loss @ IF=30MHz

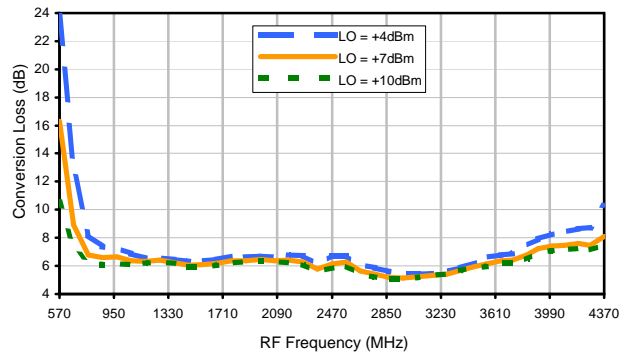

Conversion Loss vs. LO @ RF=2475MHz

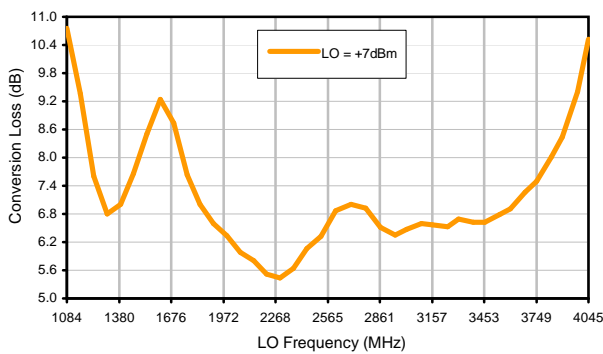

Conversion Loss vs. IF @ RF=2475MHz

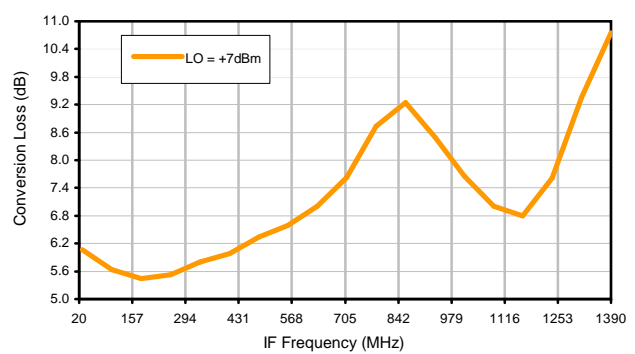

Conversion Loss vs. IF @ RF=739.9MHz

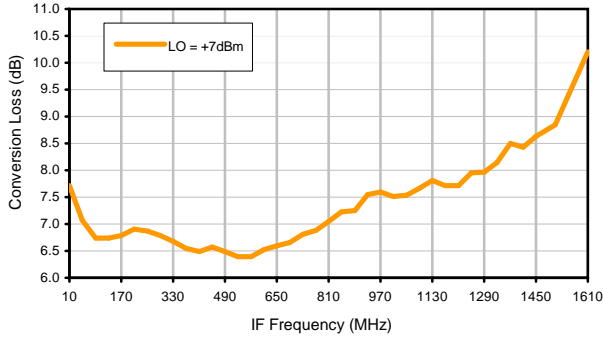

Conversion Loss vs. IF @ RF=4210MHz

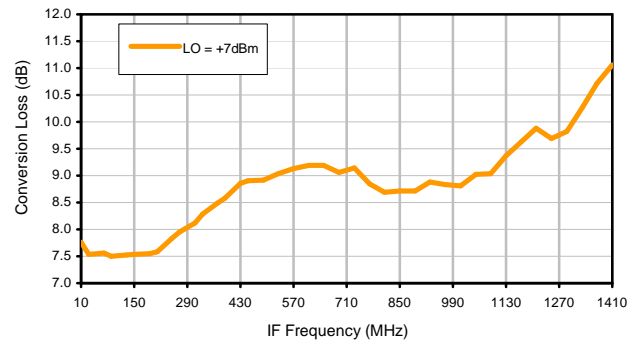

IP3 Input

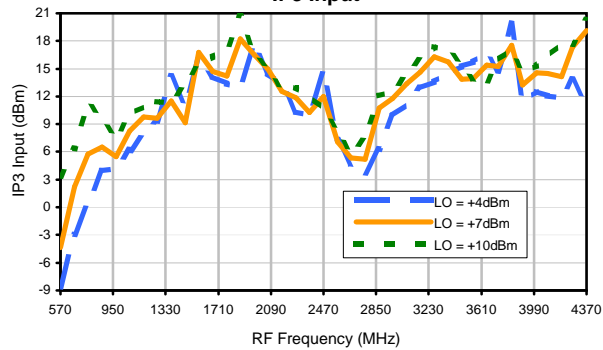

Compression @ RF IN=+1dBm

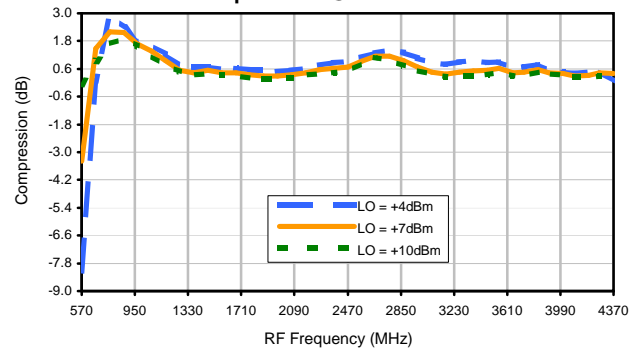

Typical Performance Curves

LO-RF Isolation

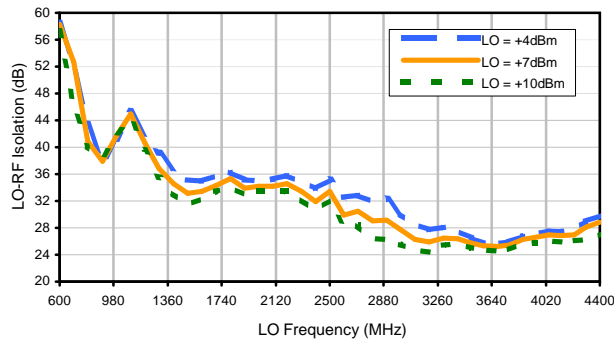

LO-IF Isolation

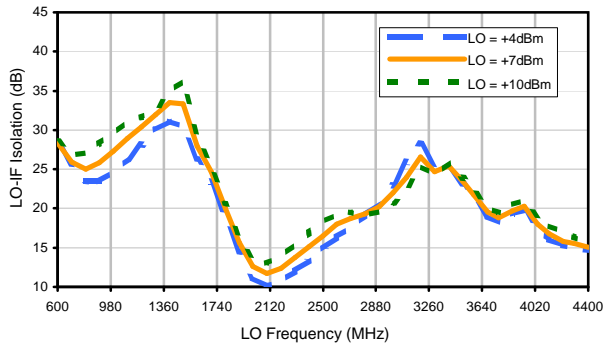

RF-IF Isolation

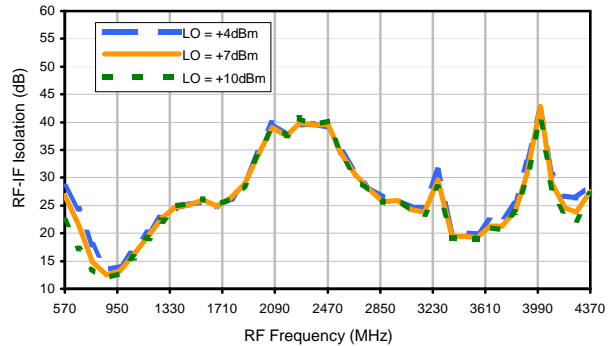

RF VSWR

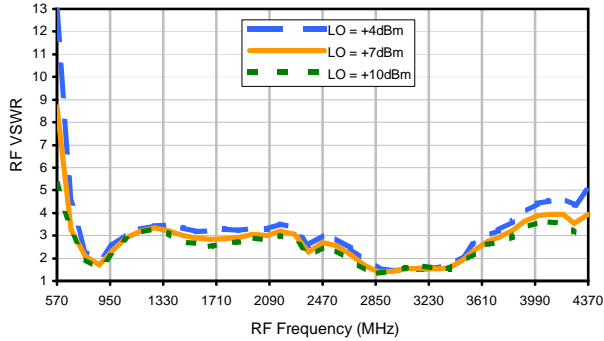

LO VSWR

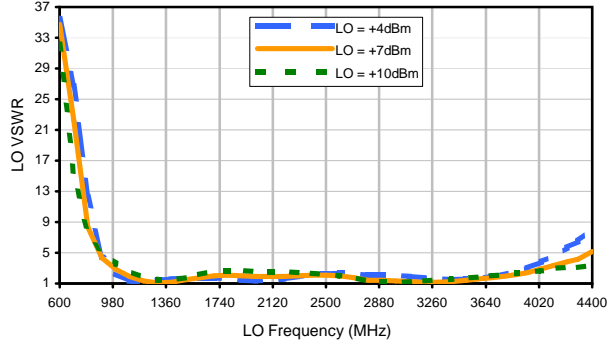

IF VSWR

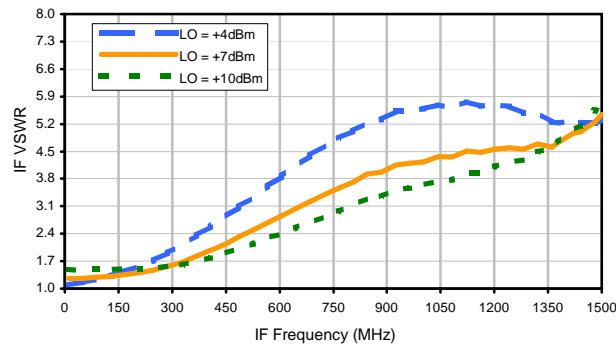

Harmonics Tables

RF HARMONICS ORDER

	(-dBm)	(-dBc)										
0	-	-	+11	9	9	30	26	42	36	45	41	---
1	-	33	+0	41	18	31	33	>70	48	>70	55	60
2	>90	55	56	61	53	69	54	61	67	>70	>70	>70
3	>90	65	63	>70	63	>70	67	>70	69	>70	>70	>70
4	>90	>70	>70	>70	>70	>70	>70	>70	>70	>70	>70	>70
5	>90	>70	>70	>70	>70	>70	>70	>70	>70	>70	>70	>70
6	>90	>70	>70	>70	>70	>70	>70	>70	>70	>70	>70	>70
7	>90	>70	>70	>70	>70	>70	>70	>70	>70	>70	>70	>70
8	>90	>70	>70	>70	>70	>70	>70	>70	>70	>70	>70	>70
9	>90	>70	>70	>70	>70	>70	>70	>70	>70	>70	>70	>70
10	---	---	>70	>70	>70	>70	>70	>70	>70	>70	>70	>70
	RF CAL	0	1	2	3	4	5	6	7	8	9	10

LO HARMONICS ORDER

Test conditions: RF IN: 2475 MHz; -14.00 dBm.
 LO IN: 2505 MHz; +7.00 dBm
 IF OUT: 30 MHz; -20.26 dBm

RF HARMONICS ORDER

	(-dBm)	(-dBc)										
0	-	-	+1	19	19	47	38	53	50	57	53	---
1	-	32	+0	43	18	36	33	71	47	73	60	62
2	71	47	49	48	45	56	48	55	58	70	71	71
3	>90	44	40	65	40	61	47	49	53	>80	67	>80
4	>90	70	62	62	62	57	63	64	62	67	79	75
5	>90	75	66	70	61	>80	56	>80	62	77	68	>80
6	>90	>80	>80	>80	>80	75	79	68	80	78	78	>80
7	>90	>80	>80	>80	>80	>80	77	>80	71	>80	>80	>80
8	>90	>80	>80	>80	>80	>80	>80	>80	>80	>80	>80	>80
9	>90	>80	>80	>80	>80	>80	>80	>80	>80	>80	>80	>80
10	---	---	>80	>80	>80	>80	>80	>80	>80	>80	>80	>80
	RF CAL	0	1	2	3	4	5	6	7	8	9	10

LO HARMONICS ORDER

Test conditions: RF IN: 2475 MHz; -4.00 dBm.
 LO IN: 2505 MHz; +7.00 dBm
 IF OUT: 30 MHz; -10.31 dBm

Notes: 1. All Harmonics are in (dBc) relative to IF OUTPUT.
 2. + entry denotes harmonics are in (dBc) above IF OUTPUT.

Outline Dimensions

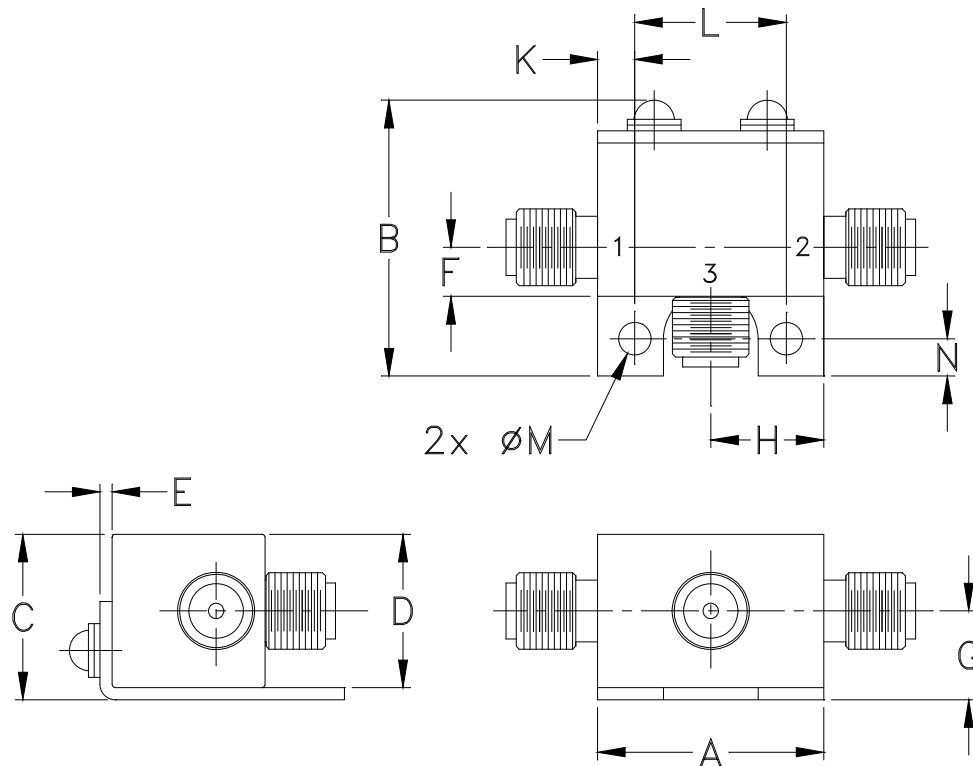

CASE #.	A	B	C	D	E	F	G	H	J	K	L	M	N	WT, GRAM
FL905	.74 (18.80)	.90 (22.86)	.54 (13.72)	.50 (12.70)	.04 (1.02)	.16 (4.06)	.29 (7.37)	.37 (9.40)	- -	.122 (3.10)	.496 (12.60)	.106 (2.69)	.122 (3.10)	20.0

Dimensions are in inches (mm). Tolerances: 2Pl. $\pm .03$; 3Pl. $\pm .015$.
Tolerance on hole size and interaxes dimensions to be $\pm .005$.

Notes:

1. Case material: Brass.
2. Case finish: Nickel plate.

Mini-Circuits®

INTERNET <http://www.minicircuits.com>

P.O. Box 350166, Brooklyn, New York 11235-0003 (718) 934-4500 Fax (718) 332-4661

Distribution Centers NORTH AMERICA 800-654-7949 • 417-335-5935 • Fax 417-335-5945 • EUROPE 44-1252-832600 • Fax 44-1252-837010

Mini-Circuits ISO 9001 & ISO 14001 Certified



All Mini-Circuits products are manufactured under exacting quality assurance and control standards, and are capable of meeting published specifications after being subjected to any or all of the following physical and environmental test.

Specification	Test/Inspection Condition	Reference/Spec
Operating Temperature	-40° to 85°C	Individual Model Data Sheet
Storage Temperature	-55° to 100° C Ambient Environment	Individual Model Data Sheet
Barometric Pressure	100,000 Feet	MIL-STD-202, Method 105, Condition D
Humidity	90% RH, 65°C Units may require bake-out after humidity to restore full performance.	MIL-STD-202, Method 103
Thermal Shock	-65° to 125°C, 5 cycles	MIL-STD-202, Method 107, Condition B
Vibration (High Frequency)	20g peak, 10-2000 Hz, 12 times in each of three perpendicular directions (total 36)	MIL-STD-202, Method 204, Condition D
Mechanical Shock	100g, 6ms sawtooth, 3 shocks each direction 3 axes (total 18)	MIL-STD-202, Method 213, Condition I